

# Technical information for hinges

## Hinges

In the tables on the following pages are listed a large range of hinge variations. Many more variations are possible if hinges with guide tabs are required i.e. when combining aluminium profiles with different slot widths.

## By the way,

hinges are supplied with a stainless steel hinge pin as standard.

Hinges 27853 and 27868 are supplied with a steel hinge pin.

## Left and right hinge

Each lift-off hinge has a left and right version, before ordering it should be known on which side the door or hatch is to be mounted.

### Left hinge.

The left hinge half is fixed.  
The hatch or door opens from right to left.

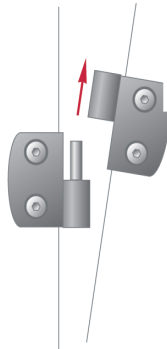

### Right hinge.

The right hinge half is fixed.  
The hatch or door opens from left to right.

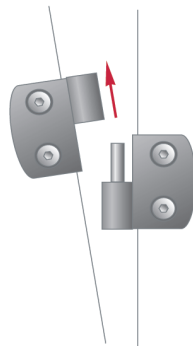

### Fixed hinge.

The hinge is non-liftoff.  
It is suitable for opening left or right.

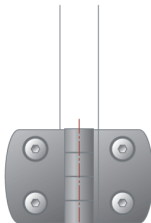

## Guide tabs

Many hinges can be supplied on request with guide tabs for the slots of aluminium profiles. They secure the hinge against twisting and make it stronger. The hinges are designed in such a way that the guide tabs can simply be broken out with a screwdriver.

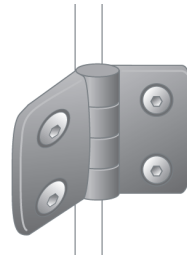

without  
locating tabs



with  
locating tabs  
for aluminium  
profiles with slot

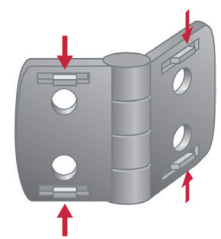

## Tip

If you want to fit a door or hatch so that it cannot be lifted off, you can still use a left and right lift-off hinge. The two hinges are fitted in the end position and secure each other mutually.

